

<b>ALTA</b>	<b>MODEL YS 1500 SS</b> <b>1500# ANSI STAINLESS STEEL</b> <b>SCREWED / SOCKET WELD</b> <b>"Y" STRAINER</b>	<b>DRAWING A 62</b>
-------------	---------------------------------------------------------------------------------------------------------------------	---------------------

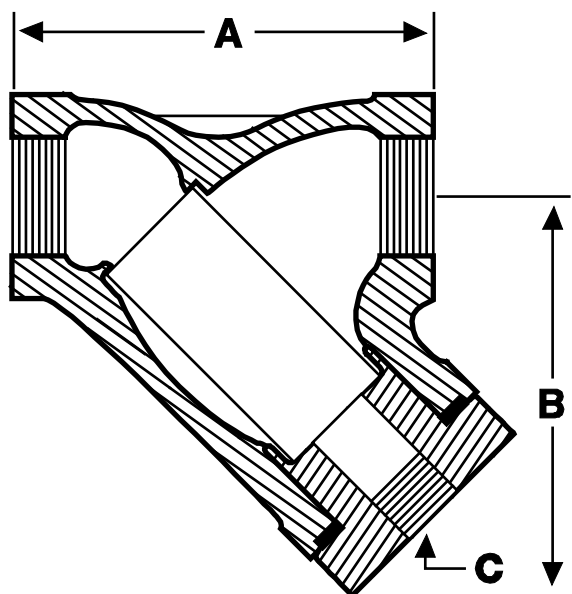

DESCRIPTION	MATERIAL
BODY	ASTM A351 GR. CF8M
CAP	ASTM A351 GR. CF8M
GASKET	SPIRAL WOUND SS
SCREEN	304 SS 1/16 PERF

TEMPERATURE		WORKING PRESSURE	
C	F	kPa	P.S.I.
-29 to 38	-20 to 100	24822	3600
95	200	21340	3095
150	300	19272	2795
200	400	17720	2560

**ALL STRAINERS ARE INDIVIDUALLY HYDROSTATICALLY TESTED TO ANSI B16.5**

SIZE		DIMENSIONS						SCREEN REMOVAL		NET WEIGHT	
		A		B		C					
mm	in.	mm	in.	mm	in.	mm	in.	mm	in.	Kg.	Lbs.
15	1/2	120	4 3/4	95	3 3/4	10	3/8	114	4 1/2	2	4 1/2
20	3/4	120	4 3/4	95	3 3/4	10	3/8	114	4 1/2	2	4 1/2
25	1	140	5 1/2	120	4 3/4	15	1/2	152	6	3.6	8
40	1 1/2	181	7 1/8	152	6	20	3/4	178	7	7.2	16
50	2	211	8 5/16	170	6 5/8	25	1	241	8	10	22

## FEATURES

**BODY HAS A MACHINED SEAT TO HOLD SCREEN SECURELY.**

**CAP HAS A MACHINED SCREEN HOLDER TO ALIGN SCREEN DURING INSTALLATION AND TO RETAIN SEDIMENT WHEN CAP IS REMOVED.**

**BODY IS MACHINED TO HOLD CAP GASKET IN A BLOW-OUT PROOF DESIGN.**